



Department of
Planning

Map Title

Legend



1: 72,223

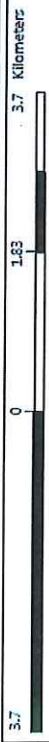

This map is a user-generated static output from an Internet mapping site and is for reference only. Data layers that appear on this map may or may not be accurate, current, or otherwise reliable.
THIS MAP IS NOT TO BE USED FOR NAVIGATION

Notes



Map Title

Legend



1:72,223



This map is a user generated static output from an internet mapping site and is for reference only. Data layers that appear on this map may or may not be accurate, current, or otherwise reliable.

THIS MAP IS NOT TO BE USED FOR NAVIGATION

Notes



Department of
Planning

Map Title

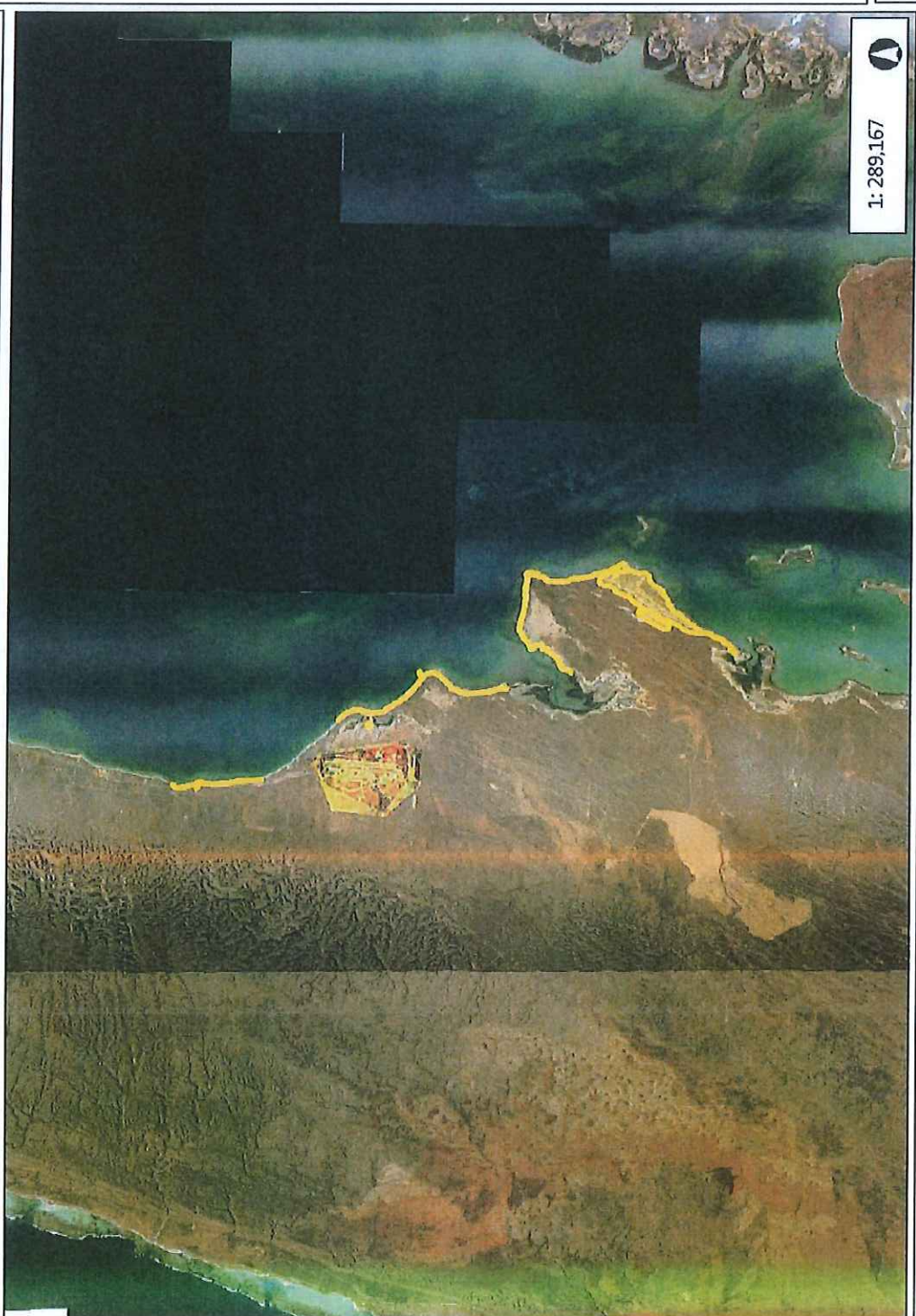

1: 289,167



This map is a user-generated static output from an Internet mapping site and is for reference only. Data layers that appear on this map may or may not be accurate, current, or otherwise reliable.
THIS MAP IS NOT TO BE USED FOR NAVIGATION

Legend

Notes



Government of Western Australia
Department of Lands

Our Ref: 00885-2014 Job No: 160353
Enquiries: LISA NICHOLAS
Ph: (08) 6552 4436 Fax: (08) 6552 4417
Email : lisa.nicholas@lands.wa.gov.au

10th of October 2016

Shire of Exmouth
PO Box 21
EXMOUTH WA 6707

Attention: Chief Executive Officer

RE: PROPOSED LICENCE OVER PORTION OF UCL ADJOINING EXMOUTH GULF STATION – SHIRE OF EXMOUTH

I refer to my previous letter dated 9 August 2016 regarding the abovementioned licence proposal. A copy of this letter is enclosed for your reference.

Unfortunately the proposed licence area has changed since my previous letter and has been amended to be larger in size.

The proposed licence area is to now comprise of three portions of UCL that are marked on the attached SmartPlan as being:

- From "A" to "B";
- From "C" to "D"; and
- From "E" to "F".

All other details of the licence proposal remain the same as those that are detailed in my previous letter.

Accordingly, please provide this Office with the Shire's comments on this licence proposal. Your general advice on this matter would also be most welcomed and appreciated.

Please do not hesitate to contact me on the details at the top right-hand side of this letter if you have any questions or require further information.

Thank you.

Yours Sincerely

A handwritten signature in blue ink, appearing to read 'Lisa Nicholas', enclosed in a blue oval.

LISA NICHOLAS
For Case Manager
MID WEST GASCOYNE REGION
REGIONAL AND METROPOLITAN SERVICES

Gordon Stephenson House, 140 William Street Perth Western Australia 6000 PO Box 1221 West Perth WA 6872
A Telephone (08) 6552 4400 Facsimile (08) 6552 4417 Freecall: 1800 735 784 (Country only)
Email: info@lands.wa.gov.au Website: www.lands.wa.gov.au
ABN: 68 565 723 484



Government of **Western Australia**
Department of **Lands**

Our Ref: 00885-2014 Job No: 160353
Enquiries: LISA NICHOLAS
Ph: (08) 6552 4436 Fax: (08) 6552 4417
Email : lisa.nicholas@lands.wa.gov.au

9 August 2016

Shire of Exmouth
PO Box 21\
EXMOUTH WA 6707

Attention: Chief Executive Officer

**RE: PROPOSED LICENCE OVER PORTION OF UCL ADJOINING EXMOUTH
GULF STATION – SHIRE OF EXMOUTH**

I refer to this Office's previous letter dated 23 June 2016 regarding the abovementioned licence proposal. The details of the proposal contained in our previous letter have changed since then thus that letter is no longer current so please disregard it.

It is now proposed to grant a licence under Section 91 of the *Land Administration Act 1997* for the purpose of 'Environmental and Land Management' for a term of five years over the following land parcel:

- Portion of unallocated crown land that adjoins Exmouth Gulf Station Pastoral Lease N50424.

The subject land of the proposed licence is shown as a red line on the enclosed SmartPlan image.

The reasoning behind granting the abovementioned licence is to enable the licensee to manage the Land in a way that allows for the Land to be free of rubbish, potential hazards on the Land to be addressed, and the monitoring of unauthorised access (ie vehicles) on/over the Land.

Please note that there will be no construction of structures on the Land nor will there be any permanent or temporary occupation of the Land involved.

Accordingly, this Office seeks the Shire of Exmouth's approval of the abovementioned licence proposal. Your general advice and comments on the proposal would also be most welcomed.

Please do not hesitate to contact me on the details at the top right-hand side of this letter if you have any questions or require further information.

Thank you.

Yours Sincerely

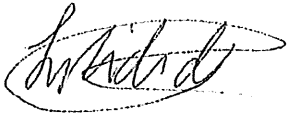
A handwritten signature in black ink, appearing to read 'Lisa Nicholas', enclosed within a faint, hand-drawn oval border.

LISA NICHOLAS
For Case Manager
MID WEST GASCOYNE REGION
REGIONAL AND METROPOLITAN SERVICES

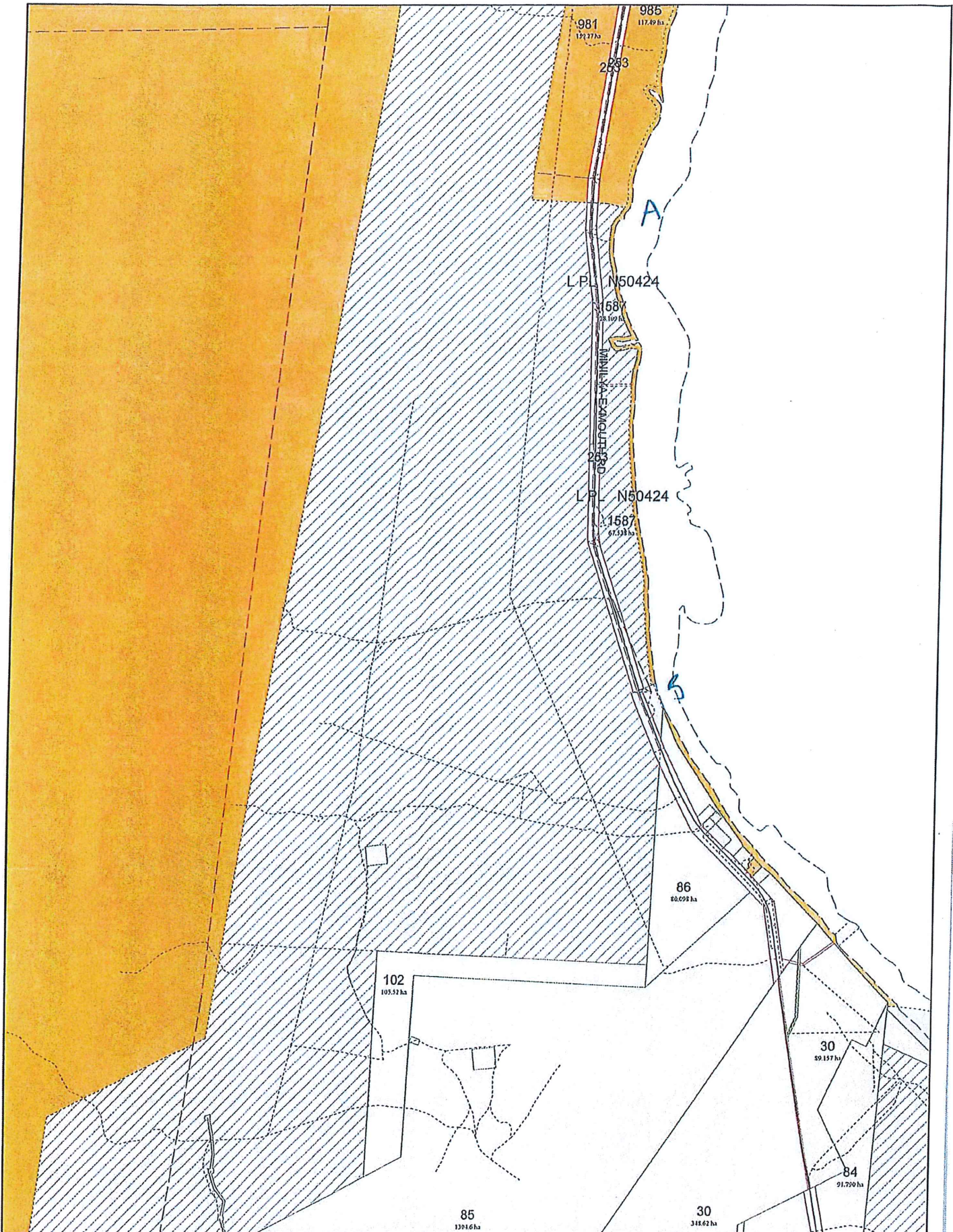

Scale : 1:41637 (MGA)
 MGA : SW=193465.033,7538246.33 Zone 50 / NE=201861.8,7549197.408 Zone 50
 Lat/Long : -22°14'02.856", 114°01'34.867" / -22°08'12.429", 114°06'35.102" H 263mm by W 202mm

Printed : 12:29 Mon 22/Aug/2016
 © Western Australian Land Information Authority 2016

This product is for information purposes only and is not guaranteed. The information may be out of date and should not be relied upon without further verification from the original documents. Where the information is being used for legal purposes then the original documents must be searched for all legal requirements.

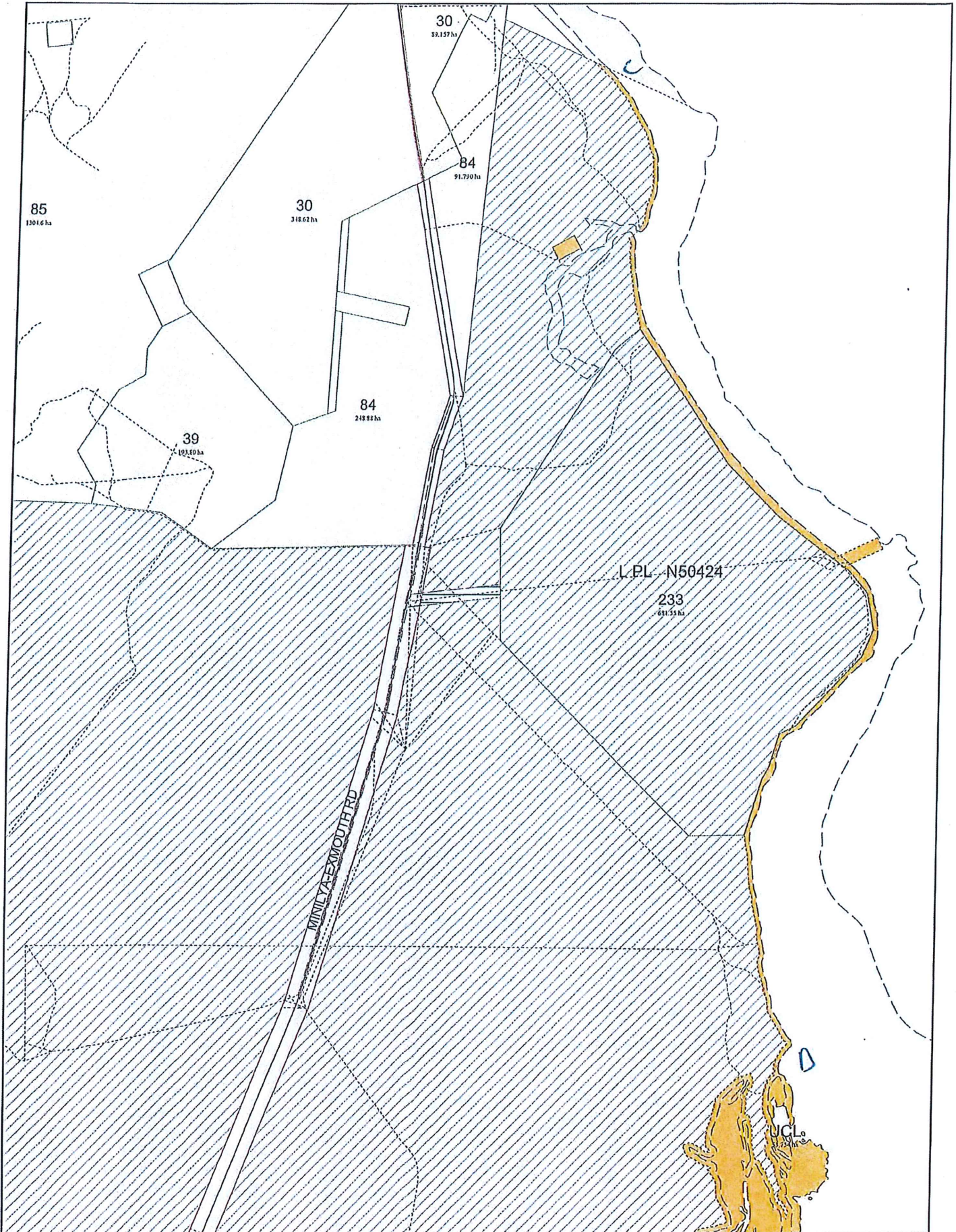

Scale : 1:37130 (MGA)
 MGA : SW=197546.169,7530310.826 Zone 50 / NE=205033.835,7540076.253 Zone 50
 Lat/Long : -22°18'23.193", 114°03'51.868" / -22°13'10.662", 114°08'19.698" H 263mm by W 202mm

Printed : 12:27 Mon 22/Aug/2016
 © Western Australian Land Information Authority 2016

This product is for information purposes only and is not guaranteed. The information may be out of date and should not be relied upon without further verification from the original documents. Where the information is being used for legal purposes then the original documents must be searched for all legal requirements.

984
29782 ha

L PL N50424

P72986
1586
34783 ha

P209470
42
3829.6 ha

L PL N50424

P72986
1586
22696 ha

